

US97 MULTI-USE PATH ALTERNATIVES EXHIBIT

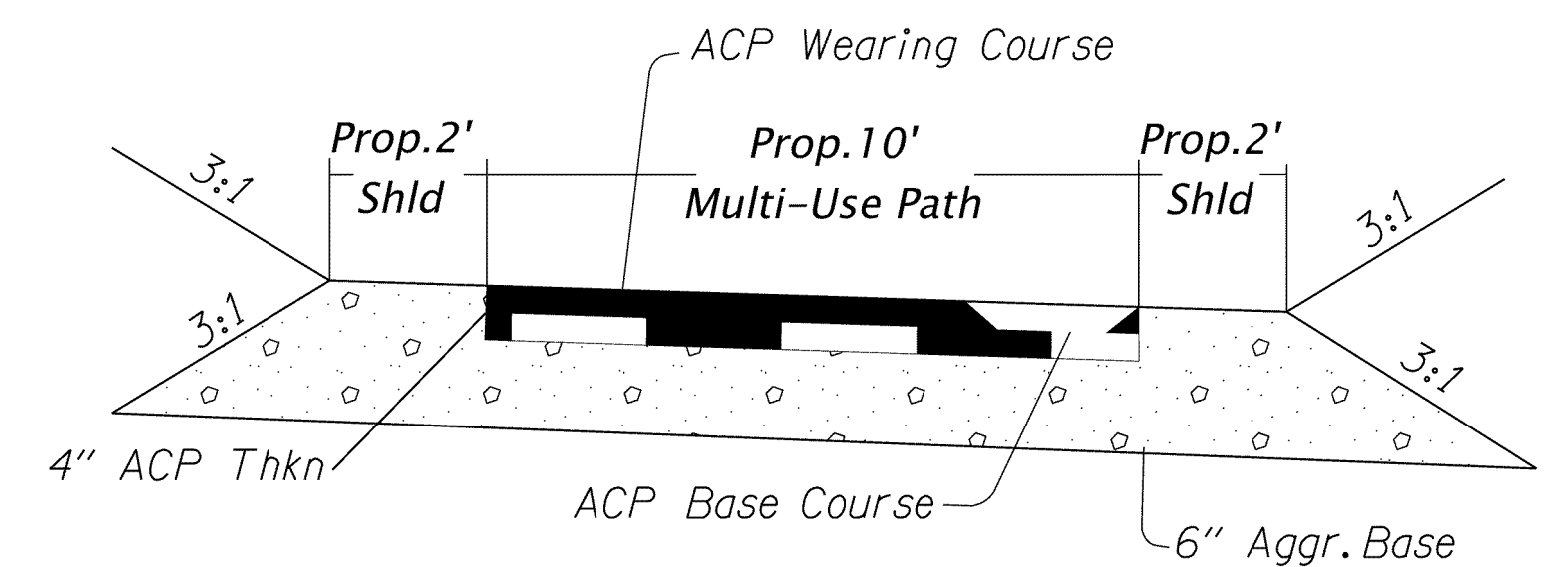
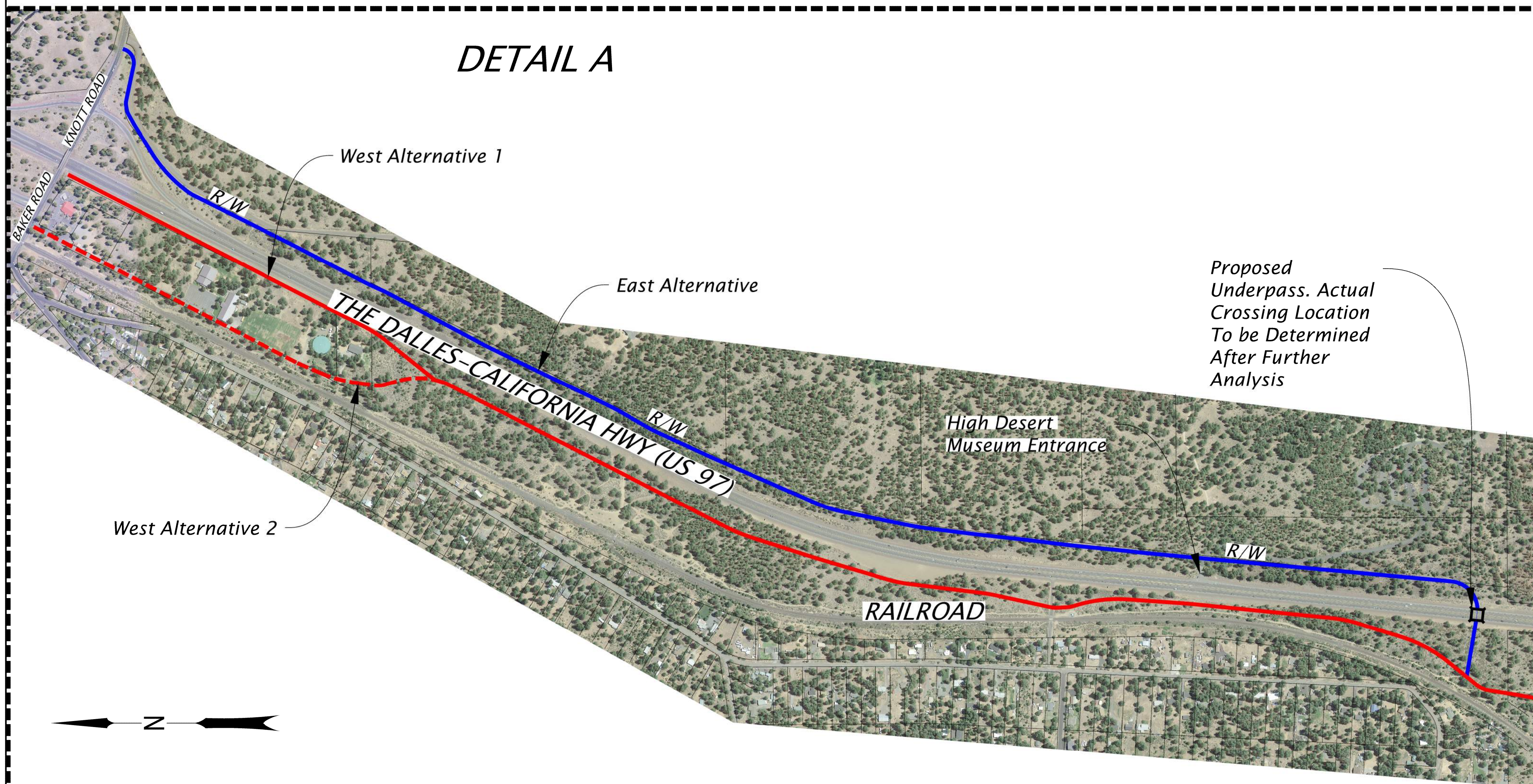
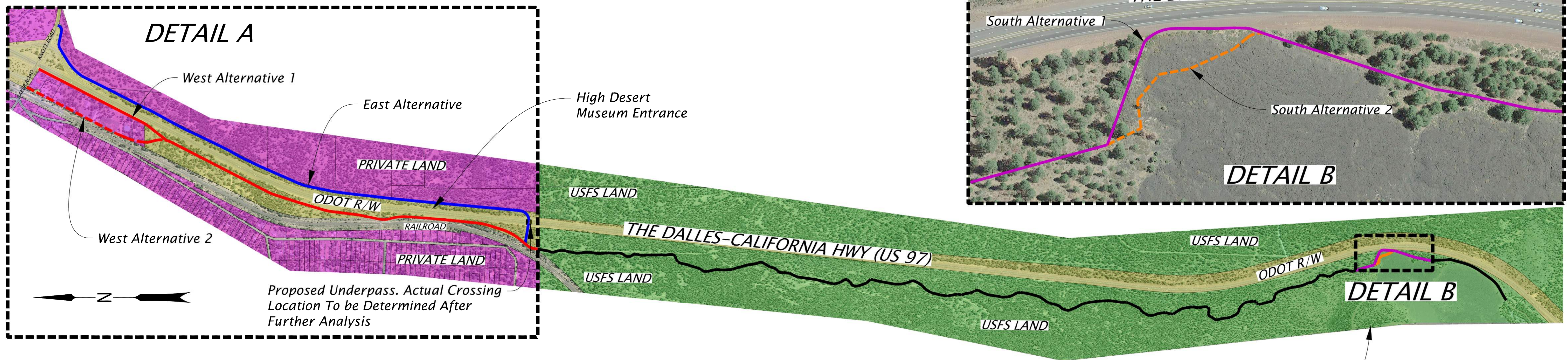

Typical Section: Proposed Multi-Use Path

Scale 1" = 1000'

**CONCEPTUAL COPY
INFORMATION ONLY**

HDR	HDR ENGINEERING, INC 404 SW COLUMBIA ST., SUITE 240 BEND, OR 97702 541.693.9020	
	DESIGNER: David Rodriguez	

US 97: MULTI-USE PATH BAKER ROAD TO LAVA BUTTE	
HIGHWAY 97 DESCHUTES COUNTY	
Drafter:	Checker:

Exhibit A	SHEET NO. 1 OF 1
------------------	---------------------